



Liquid Finger Trap Magnet

Series: LFT



BEAUTY RING INCREASES PROTECTS TUBES FROM IMPACT DURING CLEANING

POWERFUL RARE EARTH MAGNET MATERIAL (OPTIONAL HIGH TEMP MATERIAL AVAILABLE UP TO 650° F)



OPTIONAL FLANGE INCLUDES 150# OR THREADS

Application

MPI's Liquid Finger Trap Magnets are designed to protect product flow lines and pumps by magnetically removing ferrous contaminants from product flow. MPI's LFT magnets provide purification of liquids and wet separation for a variety of industries, including, but not limited to, chemicals, food processing and paper mills.

Operation

Tramp metal collects on the downstream side of the magnetic tubes, preventing tramp metal "wash-off" without restricting the product flow. Additionally, non-magnetic particles are separated, by gravity and collect in a sump beneath the magnetic element.

*Specifications subject to change

Series LFT Version 2.0 © MPI



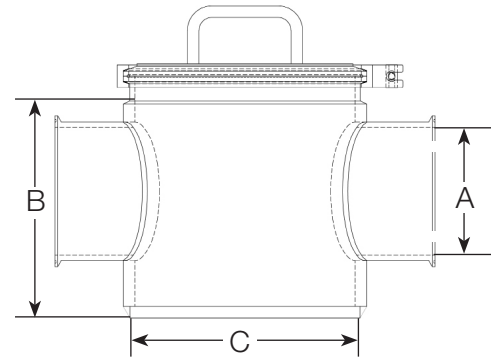
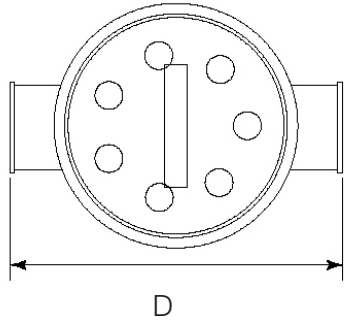
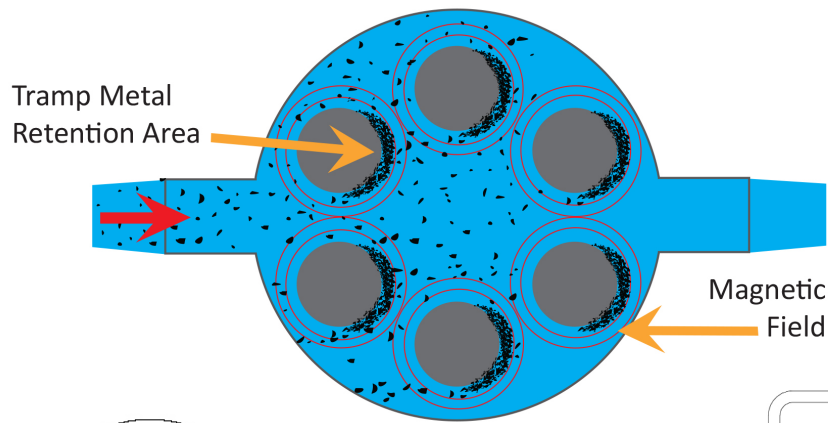

Capacities - Gallons Per Minute / Liters Per Second

LFT SIZE		Fluid and Strained Product		Fibrous and Crushed Product		Viscous and Heavy Product	
IN.	MM.	GPM	LPS	GPM	LPS	GPM	LPS
2	51	1-64	.06-4.0	1-53	.06-3.3	1.0-33	.06-2.1
3	76	65-132	4.1-8.3	54-116	3.4-7.3	34-77	2.1-4.9
4	102	133-154	8.4-9.7	117-132	7.4-8.3	78-105	4.9-6.6
6	152	365-714	23-45	220-429	14-27	145-284	9-18

LFT Series Selection Guide

LFT Model #	Pipe Diameter "A"		Height "B"		Diameter "C"		Width "D"		Approx. Unit Weight		# MAGNETIC TUBES
	IN.	MM.	IN.	MM.	IN.	MM.	IN.	MM.	LBS.	KG.	
LFT-2	2	51	7	178	6.5	165	9	229	26	12	5
LFT-3	3	76	7	178	6.5	165	9	229	37	17	5
LFT-4	4	102	8	203	8.5	216	11	279	50	23	6
LFT-6	6	152	10.5	267	10.75	273	16.5	419	125	57	7

Standard Features

- For use in pressurized systems
- Stainless steel construction
- Quick-release clamps provide easy removal for inspection and cleaning of the magnetic element
- All LFT magnets are factory pressure tested at 75 PSI

Options

- Other line connection types
- High pressure housing design
- Custom lines sizes
- USDA finish or 316 SS construction
- Drain valve
- High-temp rare earth magnet material
- Ceramic magnet material available but is not recommended for ferrous fines

**Specifications subject to change*

Series LFT Version 2.0 © MPI

