

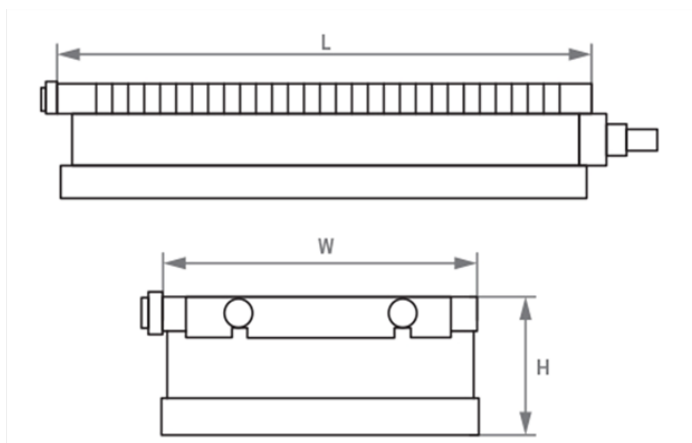

Magnetic Products, Inc.  
Highland, Michigan | mpimagnet.com

# Electromagnet Longitudinal Fine Pole Surface Grinding Chuck

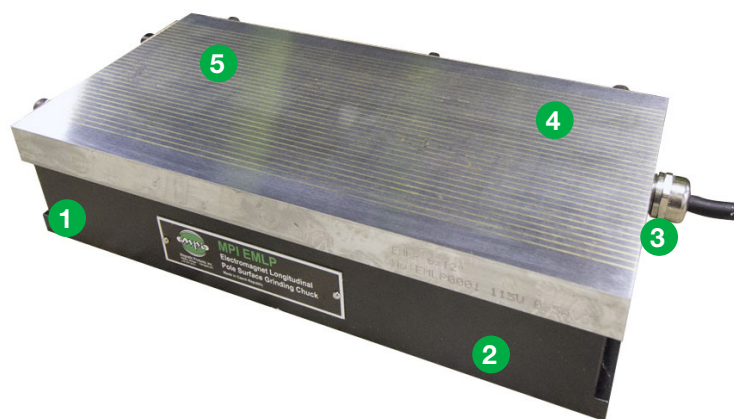

- 1 Designed with firmly embedded coils
- 2 Waterproof design
- 3 Electromagnet is easily operated by pressing the button on the control unit which also ensures variable adjustment of the force to create the optimum conditions for clamping
- 4 Suitable for sinker EDM applications
- 5 Magnetic field does not affect EDM operation

Powerful holding over entire chuck surface

Fine pole divisions – for more uniform magnetic holding of small parts

Low height for added clearance on larger workpieces

One (1) year warranty for the magnetic system

Manufactured in Europe to the highest quality standards

Included with Each Magnet: Supplied with two (2) hold down clamps

*Note: Control Unit sold separately*

**Application:** Surface grinding, EDM

**Use:** For clamping of one or more ferromagnetic workpieces on surface grinding machines during dry or wet (coolant) grinding. This chuck can also be used at checking and assembling workplaces.

**Workpiece shapes:** rectangular, circular

**Technology:** Electromagnetic

**Chuck dimensions:** from 6x12in

**Holding Force:** 90N/cm<sup>2</sup> / 130lbs/in<sup>2</sup>

**Minimum workpiece size:** 25mm x 25mm x 3mm / 1" x 1" x .12"

**Regrinding limit:** 6mm / .236"

**Pole pitch:** T4mm - 3mm+1mm / T .160" - .12"+.04" (steel/brass)

**Poles:** Parallel

Part Number	Description	Recommended Control	Width (IN)	Length (IN)	Height (IN)	Weight (LBS)	AMPS	OHMS	Volt Input	Watts
EMLP-150300-SGC	6" x 12" Electromagnet Longitudinal Fine Pole	EMCU-150W	6	12	2.8	46	0.49	233	110	57
EMLP-150450-SGC	6" x 18" Electromagnet Longitudinal Fine Pole	EMCU-150W	6	18	2.8	70	0.77	149	110	89
EMLP-200450-SGC	8" x 18" Electromagnet Longitudinal Fine Pole	EMCU-150W	8	18	2.8	100	0.98	117	110	113
EMLP-200600-SGC	8" x 24" Electromagnet Longitudinal Fine Pole	EMCU-150W	8	24	2.8	130	1.06	110	110	122
EMLP-250500-SGC	10" x 20" Electromagnet Longitudinal Fine Pole	EMCU-150W	10	20	2.8	180	1.49	77	110	172
EMLP-250600-SGC	10" x 24" Electromagnet Longitudinal Fine Pole	EMCU-150W	10	24	3	215	1.30	88	110	150
EMLP-300600-SGC	12" x 24" Electromagnet Longitudinal Fine Pole	EMCU-150W	12	24	3	185	1.24	92	110	143
EMCU-150W	Electromagnet Control Unit 150 watt capacity	-	8	12	5	12.5	-	-	-	-

*Specifications subject to change*