



**MAGNETIC PRODUCTS, INC.**

ENGINEERED METAL CONTROL SOLUTIONS

# Magnetic Tubes

Series: MT



- 1 All tube ends are fully welded for the highest durability and sanitary design, no crimped or mechanically sealed end plugs
- 2 Heavy wall thickness tube for high durability, higher performance thin tubes available and summarized in table below
- 3 Multiple designs to fit every budget and performance requirement  
Exclusive coatings available for non-stick and abrasive applications
- 4 Made in the USA  
Industry leading lead time for delivery as short as 24 hours for custom sizes and configurations

| Magnetic Tube Performance |            |          |          |                |         | 2 |
|---------------------------|------------|----------|----------|----------------|---------|---|
| Model                     | 1" Ceramic | 1" REN   | 1" Hi-G  | 1" Thin Wall** | 3" Hi-G |   |
| 1/4" Ball Pull Values*    | 0.3 lbs    | 5.0 lbs  | 5.8 lbs  | 6.5 lbs        | 6 lbs   |   |
| 1/2" Ball Pull Values*    | 1.2 lbs    | 13.0 lbs | 16.0 lbs | 16.5 lbs       | 26 lbs  |   |
| Gauss Value*              | 2,500      | 10,000   | 10,800   | 12,000         | 12,000  |   |
| Tube Durability           | ● ● ●      | ● ● ●    | ● ● ●    | ●              | ● ● ●   |   |
| Price                     | ●          | ● ●      | ● ● ●    | ● ● ●          | ● ● ●   | 3 |

\* Pull values are average on contact and gauss values are peak on contact.

\*\* Always consult a magnet professional before selecting thin wall tubes. Thin wall tubes are not recommended for products with abrasive characteristics or in manual clean designs such as grates.

how magnetic tubes work

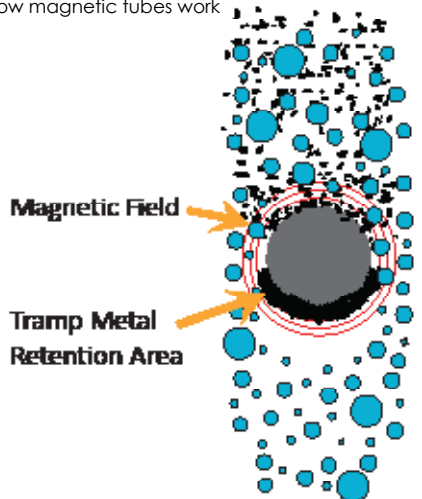

| Magnet Material Maximum Operating Temperatures |                   |        |              |
|--|-------------------|--------|--------------|
|  | REN               | Hi-G** | Thin Wall*** |
| Standard                                       | 176° @ 52-55 MGOe |        |              |
| High Temp 1                                    | 248° @ 48 MGOe    |        |              |
| High Temp 2                                    | 356° @ 38 MGOe    |        |              |
| High Temp 3                                    | 662° @ 30 MGOe    |        |              |

\* Degrees are in Fahrenheit

\*\* High Temp magnets will have lower pull values versus standard temp design due to lower MGOe material

\*Specifications subject to change

MT Version 4.1 © MPI

**MPI**

683 Town Center Drive, Highland, MI 48356 | p. 248.887.5600  
info@mpimagnet.com | www.mpimagnet.com

## Magnetic Tube Selection Guide

| MODEL NUMBER | TUBE LENGTH "A" |     | APPROX. WEIGHT |     |
|--------------|-----------------|-----|----------------|-----|
|              | IN              | MM  | LBS            | KG  |
| MT-104       | 4.0             | 102 | 0.75           | 0.3 |
| MT-106       | 6.0             | 152 | 1.12           | 0.5 |
| MT-108       | 8.0             | 203 | 1.50           | 0.7 |
| MT-110       | 10.0            | 254 | 1.87           | 0.9 |
| MT-112       | 12.0            | 305 | 2.24           | 1.0 |
| MT-114       | 14.0            | 356 | 2.62           | 1.2 |
| MT-116       | 16.0            | 406 | 2.99           | 1.4 |
| MT-118       | 18.0            | 457 | 3.37           | 1.5 |
| MT-120       | 20.0            | 508 | 3.74           | 1.7 |
| MT-122       | 22.0            | 559 | 4.11           | 1.9 |
| MT-124       | 24.0            | 610 | 4.49           | 2.0 |

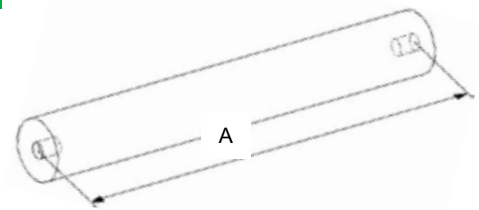

## Magnetic Tube Selectable Options

### Tube Diameter:

- **1" diameter**
- 3" diameter (available for self-clean and quick clean only)

### Tube Length:

Available lengths from 4" to 36" in any increment. For sizes over 36", MPI reviews per application to ensure that product will meet life expectancy requirements.

### Material Construction:

- **304 Stainless Steel (standard)**
- 316 Stainless Steel

### Magnetic Tubes:

- Ceramic
- **REN Rare Earth (standard)**
- Hi-G high performance Rare Earth
- TW Thin Wall high performance Rare Earth

### Magnetic Material Temperature:

- 400° @ 3.5 MGO (ceramic)
- **176 F @ 52-55 MGOe (rare earth) (standard)**
- 248° @ 48 MGO (rare earth)
- 356° @ 38 MGO (rare earth)
- 662° @ 30 MGO (rare earth)

### Tube Coatings:

- **Stainless steel with no coating (standard)**
- Synergistic Coating [reference datasheet Synergistic Coating]

### Washdown / Liquid Tight Design:

- **Non-washdown for dry applications (standard)**
- Washdown design with liquid tight tube for liquid or washdown applications

MPI can manufacture your tube with any end plug required for easy installation into your application.

### Tube end design (end 1):

- **1/4-20 tapped (standard)**
- 3/8-16 tapped
- Plain end
- Bullet nose end
- Bullet nose end 1/4-20 tapped
- Customer specified

### Tube end design (end 2):

- **1/4-20 tapped (standard)**
- 3/8-16 tapped
- Plain end
- Bullet nose end
- Bullet nose end 1/4-20 tapped
- Customer specified

MPI can manufacture your tubes with dead space on one or both ends to make metal removal easier. Note that there will be no magnetic protection in the dead space area and therefore should be located outside of the product flow area.

### Dead space length:

- **No dead space, full magnetic tube (standard)**
- 2" dead space (slightly magnetic at end of tube)
- 4" dead space (no residual magnetism at end of tube)

### Dead space location:

- Not applicable
- End 1
- End 2
- Both ends

\*Specifications subject to change